

# Fitting Instructions

Fitting Difficulty



## MQB Evo High Output 2.0TSI Open Cone Intake kit

### Contents

Description	Quantity
Intake hose	1
Repalcment Hi Flo Filter	1
Machined DV adapter	1
Carbon lid	1
TPR Rubber washers	8
90-110 Hose clamp	1
70-90 Hose clamps	1
25-40 Hose clamp	1

### Recommended Tools

Tools	Size
Ratchet	
Sockets	7mm
Socket extension	
Torx Bits	T25
Constant Tension Pliers	



Before starting, please ensure that the engine is cool. Engine temperatures can remain high for a substantial amount of time after use.



# Fitting Instructions

## MQB Evo High Output 2.0TSI Open Cone Intake kit

Fitting Difficulty



- 1 Loosen hose clamp at rear of pipe and then remove the tension clamp at the airbox end.

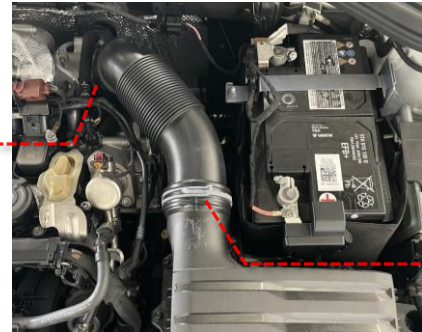

- 2 Remove the intake pipe from the car, unclipping the DV hose from the bottom of the pipe.



- 3 Remove airbox by first disconnecting the breather hose at side of airbox and then pull up and off the rubber mountings.

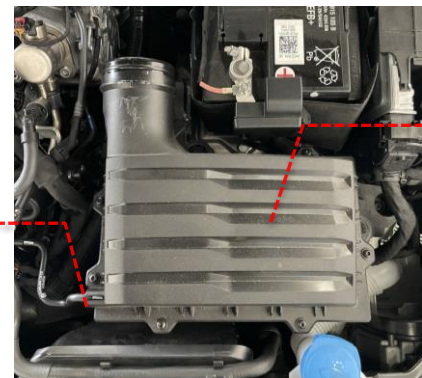

- 4 Assemble the intake hose with the machined DV adapter using the 25-40 hose clamp. Leave loose until you have connected the DV pipe to allow for fitment.



# Fitting Instructions

Fitting Difficulty



## MQB Evo High Output 2.0TSI Open Cone Intake kit

- 5 Install new intake hose using eth 70-90 hose clamp, clipping the DV pipe to the machined adapter and tighten the hose clamp.

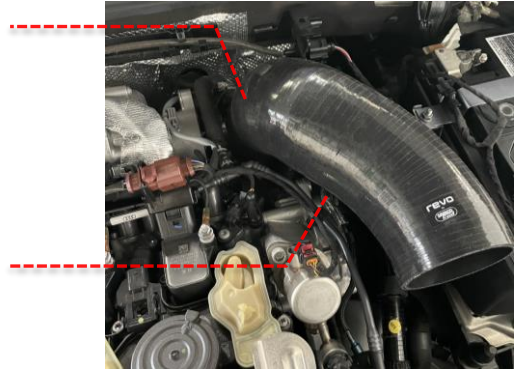

- 6 Assemble the supplied hose clamp bracket, Revo hose bracket and (1) of the included 90-110mm hose clamps as shown. Do not tighten the M8 nylon lock nut at this time

**Note:** Be sure the Revo pipe bracket is oriented as shown

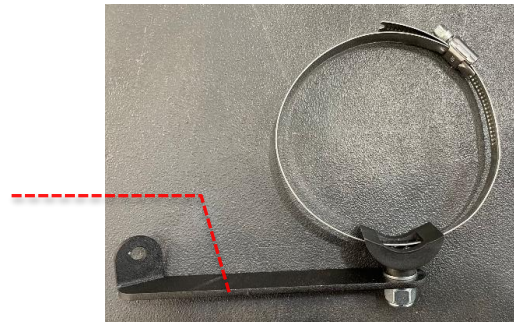

- 7 Remove the bolt shown from the engine head with a T30 Torx bit

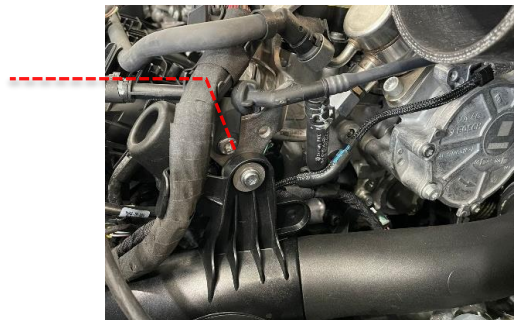

- 8 Using one of the supplied M6 x 20mm cap head bolts and M6 washers, as well as a 5mm hex bit, install the Revo bracket assembly into the engine bay as shown. Torque the bolt to 9 ft.-lbs. (12Nm)

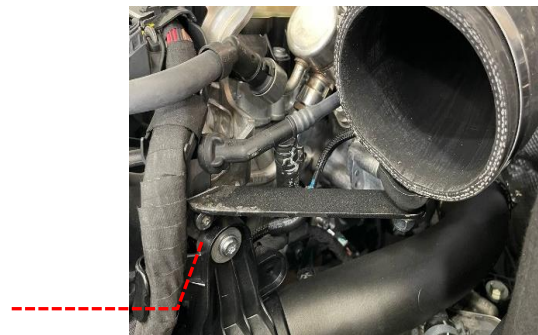

# Fitting Instructions

Fitting Difficulty



## MQB Evo High Output 2.0TSI Open Cone Intake kit

- 8 Install (2) of the supplied airbox grommets into the Revo heatshield and the remaining grommet into the Revo heatshield bracket. Install the Revo heatshield bracket onto the Revo heatshield as shown, using the remaining M6 bolts, washers and lock nuts supplied as well as a 5mm hex bit and 10mm socket. Tighten the M6 bolts/nuts fully

**Note:** Be sure the Revo heatshield bracket is oriented as shown, the bolts are installed in the direction shown and the supplied grommets are installed in the orientations shown

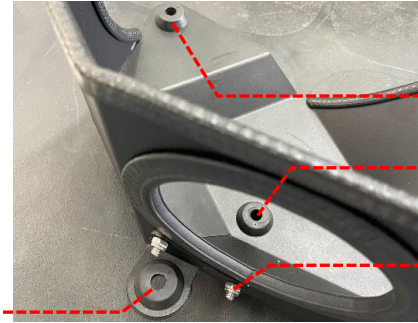

- 9 Install the Revo heatshield into the vehicle by pressing it onto the (3) chassis mounts as shown

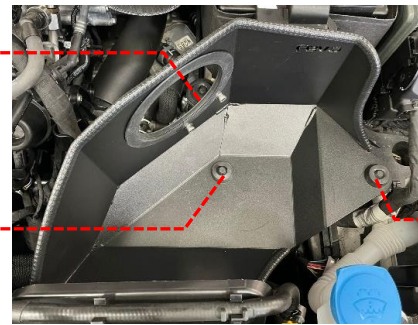

- 10 Install the Revo filter hard pipe into the Revo intake hose and tighten the 90-110mm hose clamp from the Revo pipe bracket to loosely hold the Revo hard pipe in place. Do not fully tight the hose clamp at this time. Next install the Revo rubber neck filter to the pipe using the remaining 90-110 hose clamp. Adjust the pipe and filter until positioned right and tighten hose clamps.

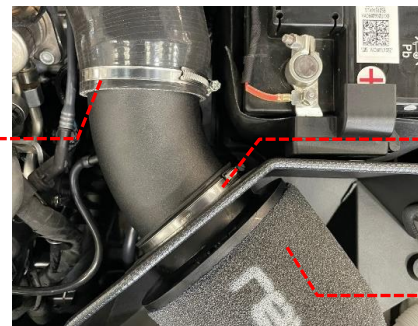

- 11 Tighten the M8 nylon lock nut on the bottom Revo pipe bracket assembly, using a 13mm socket. Connect the vacuum line to the Revo hard pipe. Check all bolts/clamps are fully tightened and reinstall the engine cover.

Test drive the vehicle to ensure vehicle performs correctly and there are no leaks/part interference during operation. Your installation is now complete!

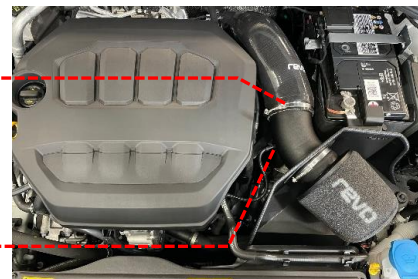

# Fitting Instructions

Fitting Difficulty



MQB Evo High Output 2.0TSI Open Cone Intake kit

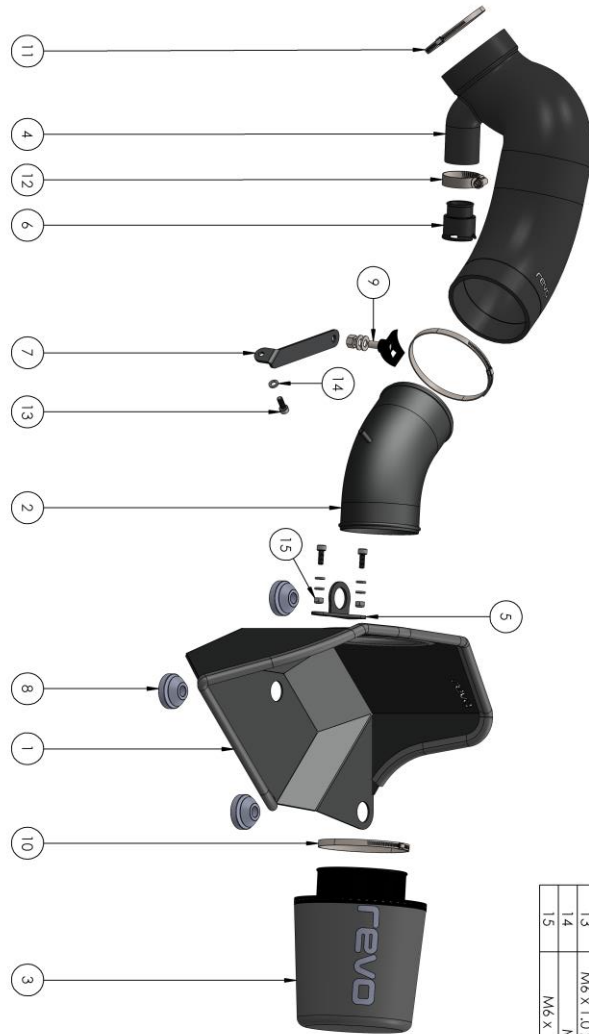

ITEM NO.	DESCRIPTION	QTY.
1	REVO HEATSHIELD	1
2	REVO AIR FILTER HARD PIPE	1
3	REVO AIR FILTER	1
4	REVO INTAKE HOSE	1
5	REVO HEATSHIELD BRACKET	1
6	REVO DV HOSE CONNECTOR	1
7	REVO MOUNTING BRACKET	1
8	OE AIRBOX GROMMET	3
9	HOSE CLAMP BRACKET ASSEMBLY	1
10	90-110MM STAINLESS STEEL WORM DRIVE HOSE CLAMP	2
11	70-90MM STAINLESS STEEL WORM DRIVE HOSE CLAMP	1
12	25-40MM STAINLESS STEEL WORM DRIVE HOSE CLAMP	1
13	M6 x 1.0 x 20MM CAP HEAD BOLT STAINLESS STEEL	3
14	M6 FLAT WASHER STAINLESS STEEL	3
15	M6 x 1.0 NYLON LOCK NUT STAINLESS STEEL	2